



Darget Mariez
Paris, France
Team leader
Pauline Mariez, France
Team members
Hannah Darget, France

B2 FREE

B2 FREE

B2 gallery



The B2 free project aims to respond to the major problem of the site:
-facilitate the connections between the levels of public spaces.

How? By creating a new ground reference level located at B2 level to link the whole site and reveal the underground spaces of the Triangle des Gares.

After lowering the existing ground, three new public spaces take place on this reference level:

- The B2 plaza allows access to the new program on level B2 and to the metro entrance under the Lille Europe station by building a ramp from Avenue Le Corbusier.
- The B2 gallery designed on a vestige of a main circulation path of the parking lot and the shopping center, enables a link between Place François Mitterand and Avenue Willy Brandt. Workshops and galleries are installed in the B2 gallery to create a cultural line between the art center Tripostal and the statue The Tulips of Yayoi Kusama.
- The B2 atrium, the former atrium of Lilleurope, is restructured to link the B2 reference level and Rotterdam forecourt. Willy Brandt Avenue is connected to this atrium by an underground axis serving sports and leisure facilities that can be used by the schools located on the upper levels.

The B2 free project reveals the underground spaces while preserving its function. Spaces dedicated to logistics and parking are preserved on the B2 reference level to encourage the diversity of programs and to preserve the functioning of the site.

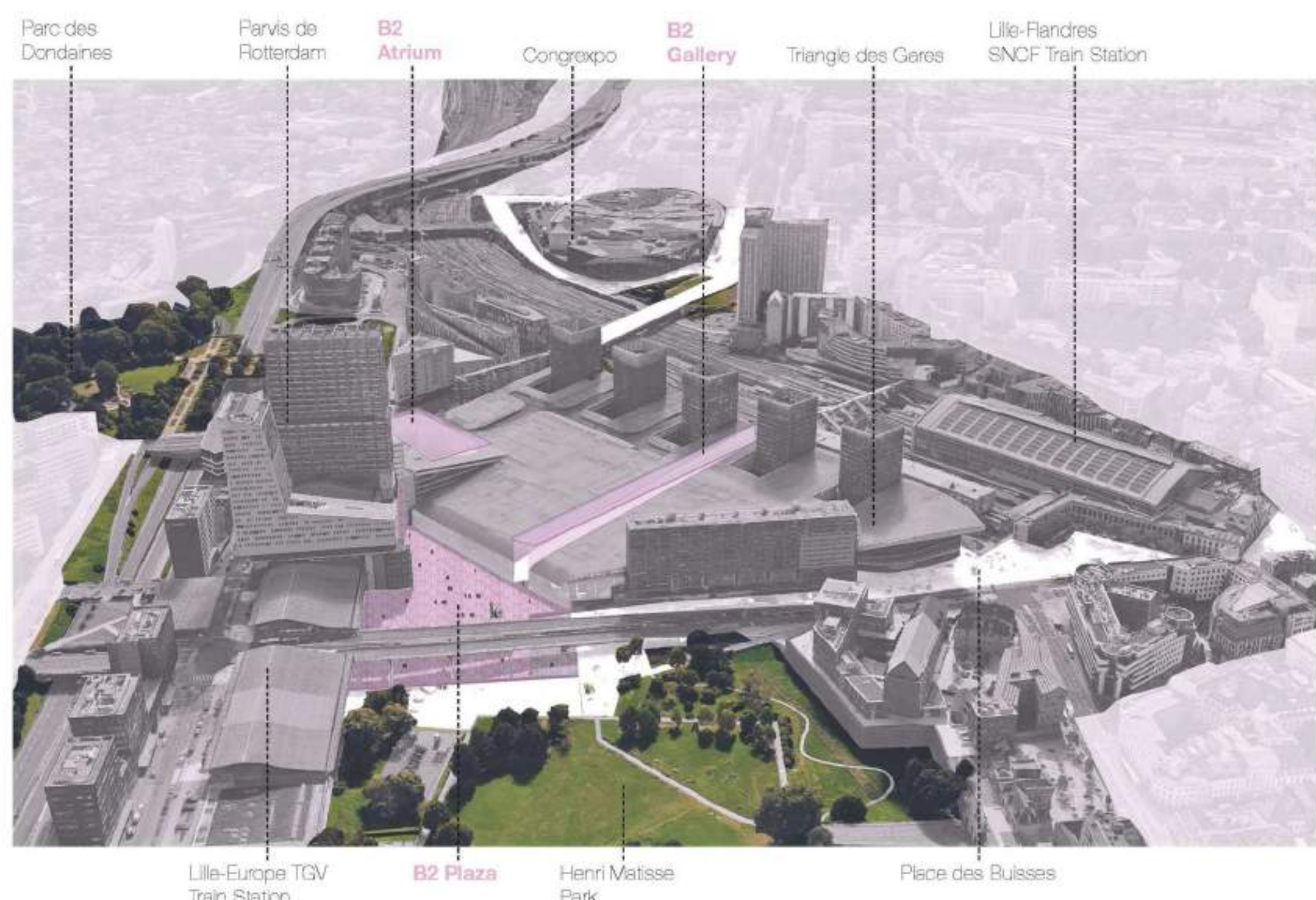

Team D563D1C8CE

B2 level

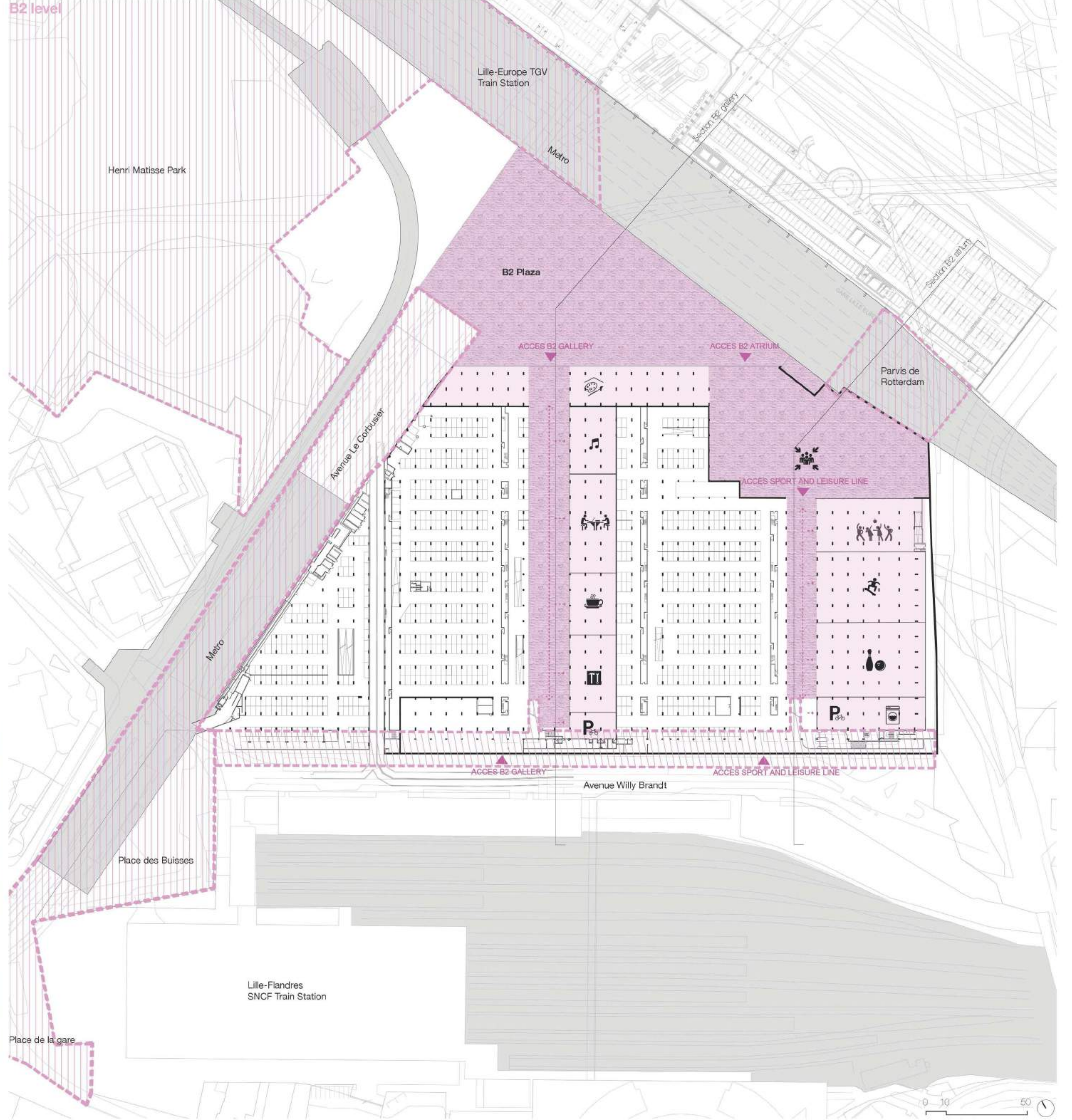

B2 FREE

Section of B2 gallery

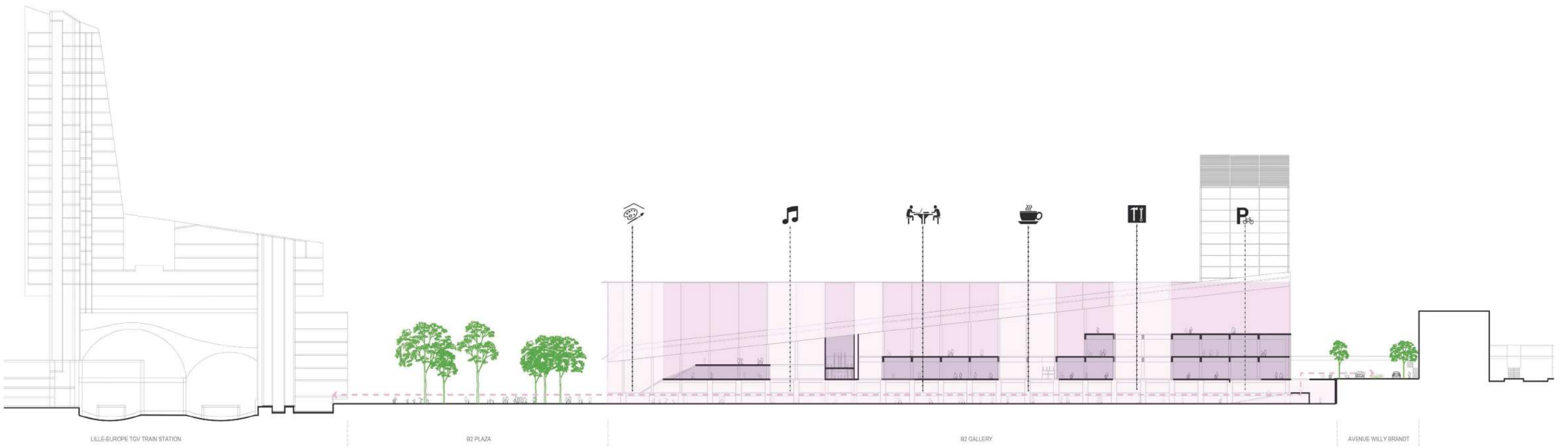

Section of B2 atrium

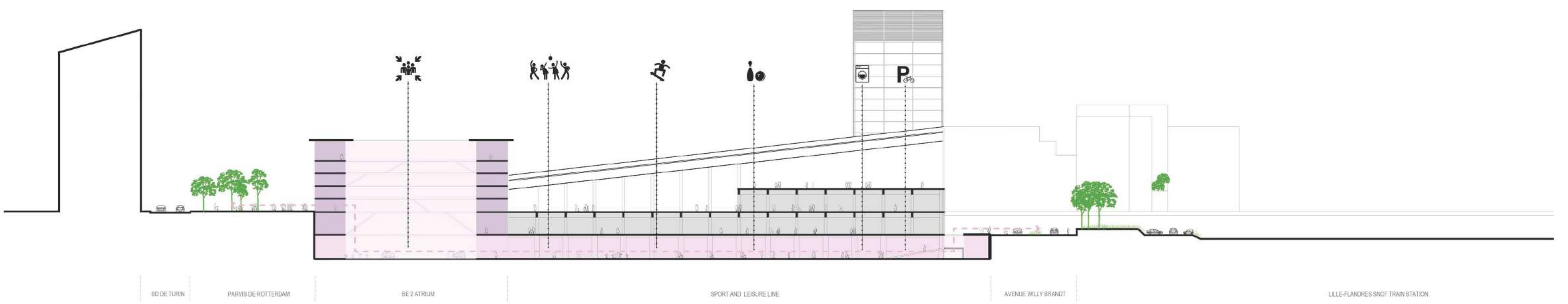

Team D563D1C8CE